

W 85 HS



W 85 HS with an intense personality!

The ingenious design and structure of the system, the solid and minimal face lines, the hidden elements, and the perfection of the design, all in one.



EN 14351-1:2006+A2:2016

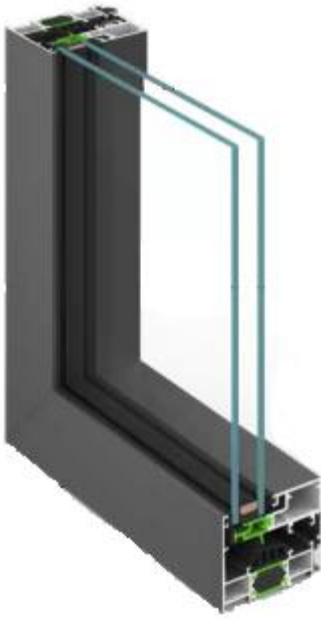

The W85HS is a highly insulated hinged system, offering the greatest possible degree of architectural design freedom by maximizing natural daylighting and granting enhanced views with outstanding insulation levels

Distinguished by its wide -picture frame- openings and the minimal elements, the system ensures a particularly bright and welcoming ambience in the interior.

Its contemporary architectural design is reflected not only in its modern appearance, but also in the minimum profile height of 56 mm, which maximizes the field of vision while allowing the maximum possible flow of natural light into the building.

The use of 30 mm glass fibre reinforced polyamides (PA66 GF25) ensures high thermal insulation with a Uf value starting from 1.4 W/m²K, while the specially designed EPDM gaskets and the advanced perimeter mechanism ensure absolute water and wind tightness.

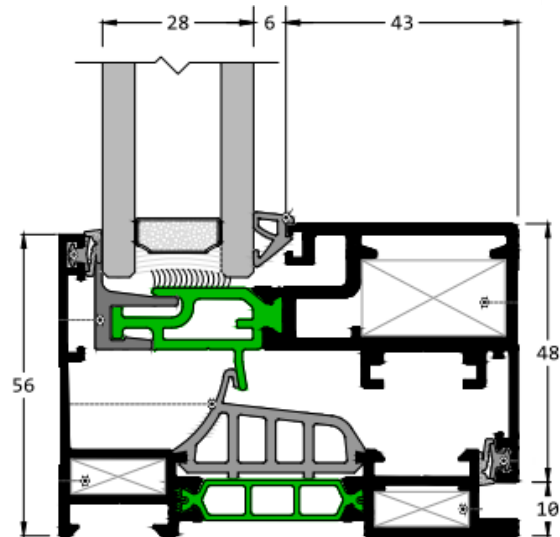

Features & Benefits

- Hidden sash with height of from 56 mm.
- Energy savings thanks to thermal performance
- Slim profiles with concealed window elements
- High level of security thanks to multiple perimeters locking
- Multi-chamber central seal that guarantees optimal waterproofness
- Possibility of using hidden hinges
- Suitable for double and triple glazing
- Wide range of typologies and solutions
- Modern design
- Ideal solution for homes and buildings.
- Window type: Casement
- Thermal insulation: Yes
- External shape: Flat



W 85 HS

 window tech



View Master

TC

Low Frame

Standard Frame

Narrow Viewing

Low Threshold

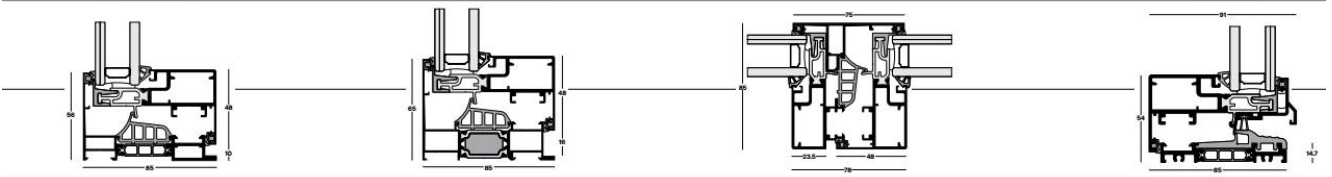
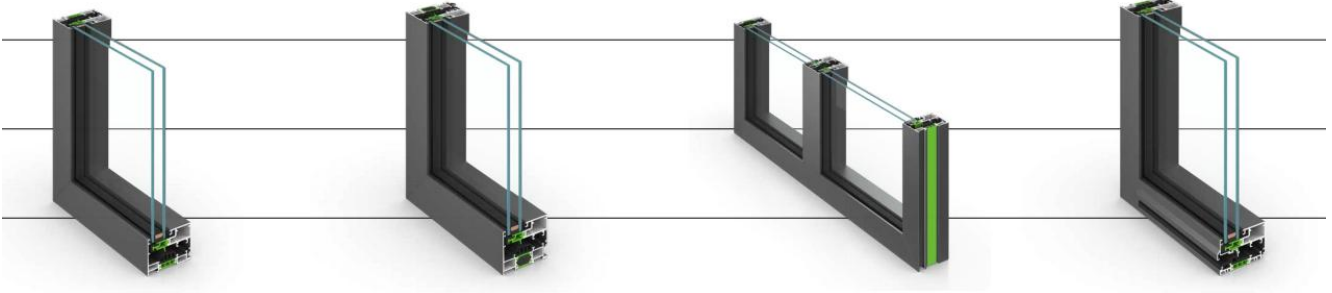

System
Technikdetails

Technical Characteristics

Performance

FRAME DEPTH:	85/92 mm	RESISTANCE TO WIND LOAD (UNI EN 12210)	Clase C4
SASH DEPTH:	78/84.5 mm	WATER TIGHTNESS (UNI EN 12208)	Classe 8A
FRAME HEIGHT:	56/65 mm	AIR PERMEABILITY (UNI EN 12207)	Classe C2/B2
MIN. WIDTH CENTRAL COLUMN	75/108 mm	THERMAL TRASMITTANCE U_f W/(m²K)	1.4
SASH WEIGHT:	up to 180 Kg	THERMAL TRASMITTANCE U_w (UNI EN ISO 10077-1)	1.2
GLAZING TYPE:	Double/Triple		
GLAZING THICKNESS:	28-40 mm		
THERMAL INSULATION:	Polyamides 30 mm, Insulation foam		
MINIMUM THRESHOLD:	14.7 mm		

TYOLOGIES



Fixed



One sash tilt and turn



One sash tilt & turn low threshold

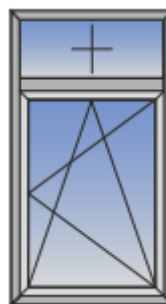

Single tilt & turn with fixed light



Single tilt & turn with fanlight

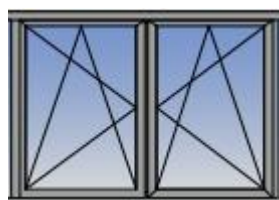

Double tilt and turn

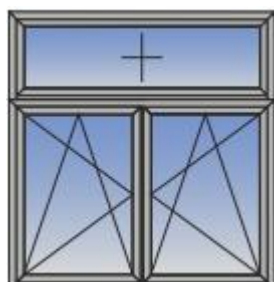

Double tilt and turn with fixed light

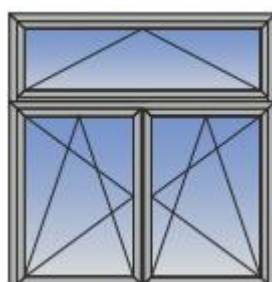

Double tilt and turn with fanlight



Double tilt and turn